

## Slat Top Steel Chain

Series **uni 812** Type -

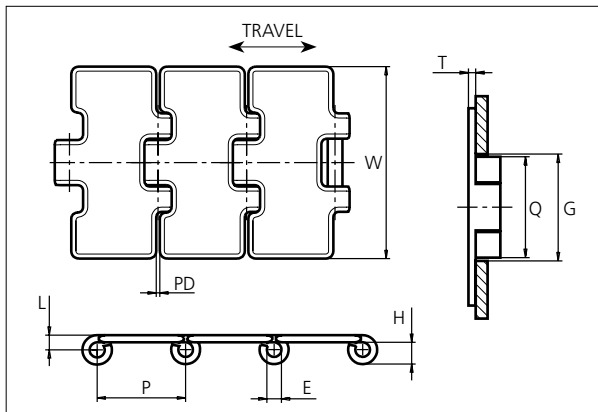

### Slat Top Steel Chain

Straight running chain  
 Pitch: 38.1 mm (1.50 in)  
 Backflex radius: 150.0 mm (5.91 in)  
 Permissible tensile strength:  
 2250 N (506 lbf)  
 Delivery: 3.048 m (10 ft)  
 No. of links/box: 80

STANDARD

| E   |      | G    |      | H   |      | L   |      | P    |      | Q    |      | T   |      | PD  |      |
|-----|------|------|------|-----|------|-----|------|------|------|------|------|-----|------|-----|------|
| mm  | in   | mm   | in   | mm  | in   | mm  | in   | mm   | in   | mm   | in   | mm  | in   | mm  | in   |
| 6.4 | 0.25 | 45.0 | 1.77 | 9.9 | 0.39 | 6.5 | 0.26 | 38.1 | 1.50 | 42.5 | 1.67 | 3.0 | 0.12 | 1.6 | 0.06 |

STRAIGHT RUNNING

|             | Width (W) |      | Material | Pin material | Weight |       |
|-------------|-----------|------|----------|--------------|--------|-------|
|             | mm        | in   |          |              | kg/m   | lb/ft |
| <b>K225</b> | 57.2      | 2.25 | SS430    | SS431        | 2.2    | 1.48  |
| <b>K250</b> | 63.5      | 2.50 | SS430    | SS431        | 2.3    | 1.55  |
| <b>K325</b> | 82.6      | 3.25 | SS430    | SS431        | 2.7    | 1.81  |
| <b>K400</b> | 101.6     | 4.00 | SS430    | SS431        | 3.0    | 2.02  |
| <b>K450</b> | 114.3     | 4.50 | SS430    | SS431        | 3.3    | 2.22  |
| <b>K600</b> | 152.4     | 6.00 | SS430    | SS431        | 4.2    | 2.82  |
| <b>K750</b> | 190.5     | 7.50 | SS430    | SS431        | 5.1    | 3.43  |

PITCH 38.1 MM/1.50 IN

### Accessories

#### Rubber Top / NON STANDARD



Sold only in full coils of:  
 3.048m (10 ft), No. of links: 80

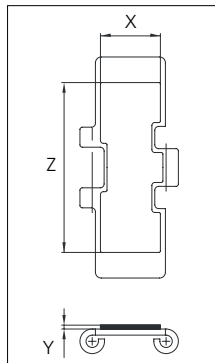

| Width       | Rubber material | Z     |      | X     |      | Y   |      |
|-------------|-----------------|-------|------|-------|------|-----|------|
|             |                 | mm    | in   | mm    | in   | mm  | in   |
| <b>K125</b> | 06 <b>K</b>     | 25.7  | 1.01 | 19.7  | 0.78 | 3.0 | 0.12 |
| <b>K325</b> | 06 <b>K</b>     | 76.7  | 3.02 | 28.8  | 1.13 | 3.0 | 0.12 |
| <b>K450</b> | 06 <b>K</b>     | 108.0 | 4.25 | 27.2* | 1.07 | 3.0 | 0.12 |
| <b>K600</b> | 06 <b>K</b>     | 146.0 | 5.75 | 30.7  | 1.21 | 3.0 | 0.12 |
| <b>K750</b> | 06 <b>K</b>     | 146.0 | 5.75 | 30.7  | 1.21 | 3.0 | 0.12 |

\* Is an average measurement, because the rubber is conical

## Sprocket

| No of teeth | Pitch diameter |      | Overall-diameter |      | Min. ø bore |     | Max. ø bore |     | Hub-diameter |      | A-dimension |      | B-dimension |      | Molded PA6 LG | Molded Cast Iron | Machined PA6  |
|-------------|----------------|------|------------------|------|-------------|-----|-------------|-----|--------------|------|-------------|------|-------------|------|---------------|------------------|--|
|             | mm             | in   | mm               | in   | mm          | in  | mm          | in  | mm           | in   | mm          | in   | mm          | in   |               |                  |  |
| Z13         | 82             | 3.22 | 79               | 3.11 | 20          | 0.8 | 40          | 1.6 | 0            | 0    | 29.8        | 1.17 | 48.1        | 1.89 |               | x                |  |
| Z19         | 117.3          | 4.62 | 117              | 4.61 | 20          | 0.8 | 40          | 1.6 | 58           | 2.28 | 58.7        | 2.31 | 64.5        | 2.54 | x             |                  |  |
| Z21         | 129.2          | 5.09 | 130              | 5.12 | 20          | 0.8 | 40          | 1.6 | 58           | 2.28 | 65          | 2.56 | 70.5        | 2.78 | x             |                  |  |
| Z23         | 141.2          | 5.56 | 142              | 5.59 | 20          | 0.8 | 40          | 1.6 | 58           | 2.28 | 71.2        | 2.80 | 76.5        | 3.01 | x             |                  |  |
| Z25         | 153.2          | 6.03 | 155              | 6.10 | 20          | 0.8 | 40          | 1.6 | 58           | 2.28 | 77.4        | 3.05 | 82.5        | 3.25 | x             |                  |  |
| Z27         | 165.2          | 6.50 | 167              | 6.57 | 20          | 0.8 | 70          | 2.8 | 0            | 0    | 83.6        | 3.29 | 88.5        | 3.48 |               | x                | x  |
| Z29         | 177.2          | 6.98 | 179              | 7.05 | 20          | 0.8 | 70          | 2.8 | 0            | 0    | 89.8        | 3.54 | 94.6        | 3.72 |               | x                | x  |
| Z31         | 189.3          | 7.45 | 192              | 7.56 | 20          | 0.8 | 70          | 2.8 | 0            | 0    | 95.9        | 3.78 | 100.6       | 3.96 |               | x                | x  |

## Two part sprocket

| No of teeth | Pitch diameter |      | Overall-diameter |      | Min. ø bore |      | Max. ø bore |      | Hub-diameter |      | A-dimension |      | B-dimension |      | Molded PA6 LG | Molded Cast Iron | Machined PA6  |
|-------------|----------------|------|------------------|------|-------------|------|-------------|------|--------------|------|-------------|------|-------------|------|---------------|------------------|--|
|             | mm             | in   | mm               | in   | mm          | in   | mm          | in   | mm           | in   | mm          | in   | mm          | in   |               |                  |  |
| Z19         | 117.3          | 4.62 | 117.0            | 4.61 | 20.0        | 0.79 | 40.0        | 1.57 | 58.0         | 2.28 | 58.7        | 2.31 | 64.5        | 2.54 | x             |                  |  |
| Z21         | 129.2          | 5.09 | 130.0            | 5.12 | 20.0        | 0.79 | 40.0        | 1.57 | 58.0         | 2.28 | 65.0        | 2.56 | 70.5        | 2.78 | x             |                  |  |
| Z23         | 141.2          | 5.56 | 142.0            | 5.59 | 20.0        | 0.79 | 40.0        | 1.57 | 58.0         | 2.28 | 71.2        | 2.80 | 76.5        | 3.01 | x             |                  |  |
| Z25         | 153.2          | 6.03 | 155.0            | 6.10 | 20.0        | 0.79 | 40.0        | 1.57 | 58.0         | 2.28 | 77.4        | 3.05 | 82.5        | 3.25 | x             |                  |  |

Molded sprocket



Cast iron sprocket



Machined sprocket



Two part sprocket



Non standard material and color:  
See uni Material and Color Overview.

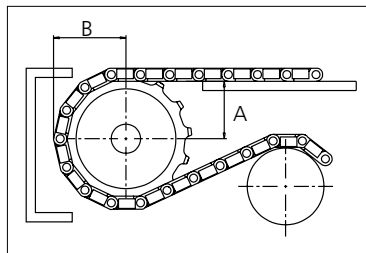

Please ensure that sufficient size shaft and keyway are chosen for corresponding load.

Other sprocket sizes are available upon request

Width of tooth: 31.8 mm/1.25 in

Width of sprocket: 42.3 mm/1.67 in

uni Retainer Rings: See uni Retainer Ring data sheet

uni Idler: See uni Idler data sheet

uni Guide Rings can be mounted on cast iron and machined sprockets. See uni Guide Rings data sheet

uni 812/1309

Any questions? Please contact us.

**Morskate Aandrijvingen BV**  
Oosterveldsingel 47A  
7558 PJ Hengelo (Ov)  
The Netherlands

NL  
T +31 (0)74 - 760 11 11  
info@morskateaanrijvingen.nl  
www.morskateaanrijvingen.nl

DE  
T +49 692 - 222 34 95  
info@morskateantriebstechnik.de  
www.morskateantriebstechnik.de

EN  
T +31 (0)74 - 760 11 11  
info@morskatedrivetechnology.com  
www.morskatedrivetechnology.com